

R5

Rotary Vane Vacuum Pumps
KD 0025 A

Instruction Manual

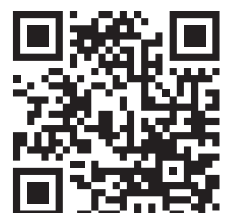

Table of Contents

1	Safety	3
2	Product Description	4
2.1	Operating Principle	5
2.2	Intended Use	5
2.3	Variants.....	6
2.4	Start Controls.....	6
2.5	Optional Accessories.....	6
2.5.1	Rubber feet	6
2.5.2	Extension Cables.....	6
3	Transport	7
4	Storage	8
5	Installation	9
5.1	Installation Conditions.....	9
5.2	Connecting Lines / Pipes	10
5.2.1	Suction Connection	10
5.2.2	Discharge Connection	10
5.3	Filling Oil.....	11
6	Electrical Connection	12
6.1	Machine delivered without Control Box or Variable Speed Drive (VSD).....	12
6.2	Wiring Diagram Single-Phase Motor	13
6.3	Wiring Diagram Three-Phase Motor.....	14
6.4	Capacitor Installation.....	15
7	Commissioning	17
7.1	Conveying Condensable Vapors.....	17
8	Maintenance	18
8.1	Maintenance Schedule	19
8.2	Oil Level Inspection	19
8.3	Oil Change.....	19
8.4	Exhaust Filter Change.....	21
9	Overhaul	22
10	Decommissioning	23
10.1	Dismantling and Disposal	23
11	Spare Parts	24
12	Troubleshooting	25
13	Technical Data	27
14	Oil	28
15	EU Declaration of Conformity	29
16	UK Declaration of Conformity	30

1 Safety

Prior to handling the machine, this instruction manual should be read and understood. If anything needs to be clarified, please contact your Busch representative.

Read this manual carefully before use and keep for future reference.

This instruction manual remains valid as long as the customer does not change anything on the product.

The machine is intended for industrial use. It must be handled only by technically trained personnel.

Always wear appropriate personal protective equipment in accordance with the local regulations.

The machine has been designed and manufactured according to state-of-the-art methods. Nevertheless, residual risks may remain, as described in the following chapters and in accordance with the chapter *Intended Use* [→ 5]. This instruction manual highlights potential hazards where appropriate. Safety notes and warning messages are tagged with one of the keywords DANGER, WARNING, CAUTION, NOTICE and NOTE as follows:



DANGER

... indicates an imminent dangerous situation that will result in death or serious injuries if not prevented.



WARNING

... indicates a potentially dangerous situation that could result in death or serious injuries.



CAUTION

... indicates a potentially dangerous situation that could result in minor injuries.



NOTICE

... indicates a potentially dangerous situation that could result in damage to property.



NOTE

... indicates helpful tips and recommendations, as well as information for efficient and trouble-free operation.

2 Product Description

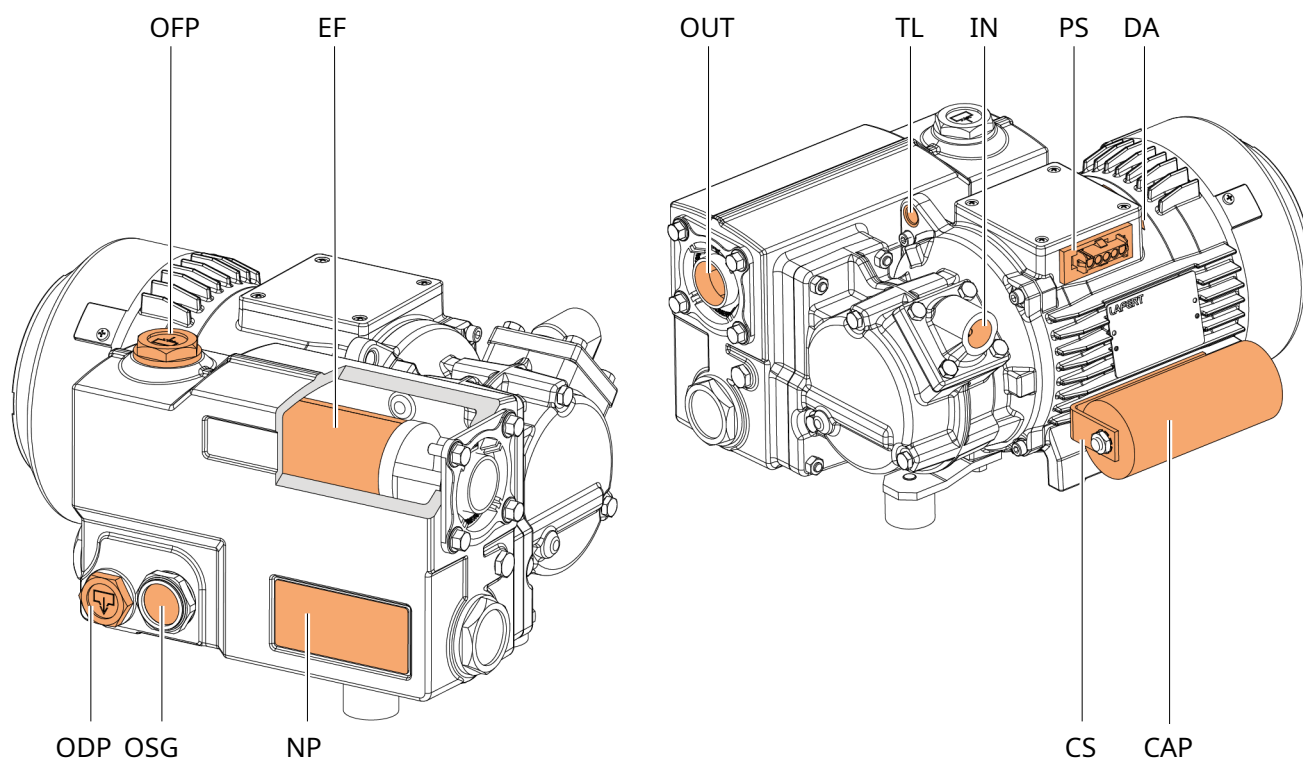

Description

OFF	Oil fill plug	EF	Exhaust filter
OUT	Gas discharge	TL	Transport lug
IN	Suction connection	PS	Power supply
DA	Directional arrow	ODP	Oil drain plug
OSG	Oil sight glass	NP	Nameplate
CS	Capacitor support	CAP	Capacitor (single-phase motor only)

NOTE

Technical term.

In this instruction manual, we consider that the term 'machine' refers to the 'vacuum pump'.

NOTE

Illustrations

In this instruction manual the illustrations may differ from the machine appearance.

2.1 Operating Principle

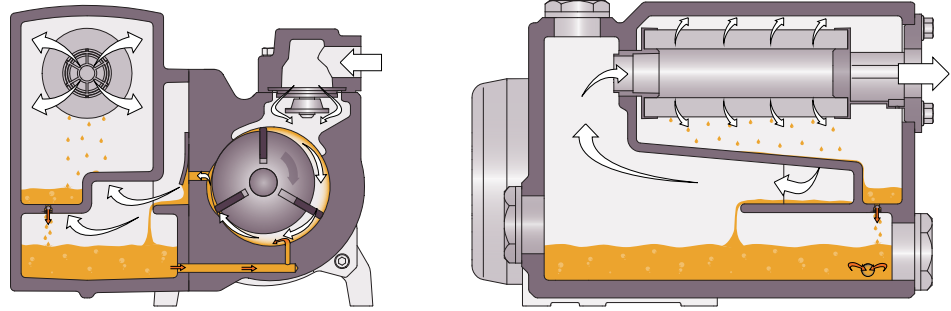

The machine works on the rotary vane principle.

The oil seals the gaps, lubricates the vanes and takes away compression heat.

In order to avoid reverse rotation after switching off, the machine is equipped with a non-return valve (NRV).

In order to avoid solids from entering, the machine is equipped with an inlet screen (IS).

Exhaust filters separate the oil from the discharged gas.

2.2 Intended Use



WARNING

In case of foreseeable misuse outside the intended use of the machine.

Risk of injuries!

Risk of damages to the machine!

Risk of damages to the environment!

- Make sure to follow all instructions described in this manual.

The machine is intended for the suction of air and other dry, non-aggressive, non-toxic and non-explosive gases.

Conveying of other media leads to an increased thermal and/or mechanical load on the machine and is permissible only after a consultation with Busch.

The machine is designed to be integrated into vacuum packaging table-top machines.

The machine is intended for the placement in a non-potentially explosive environment.

The machine is designed for indoor installation, in case of outdoor installation, ask your Busch representative in order to take specific precautions.

The machine is capable of maintaining ultimate pressure, see *Technical Data* [→ 27].

Permitted environmental conditions, see *Technical Data* [→ 27].

2.3 Variants

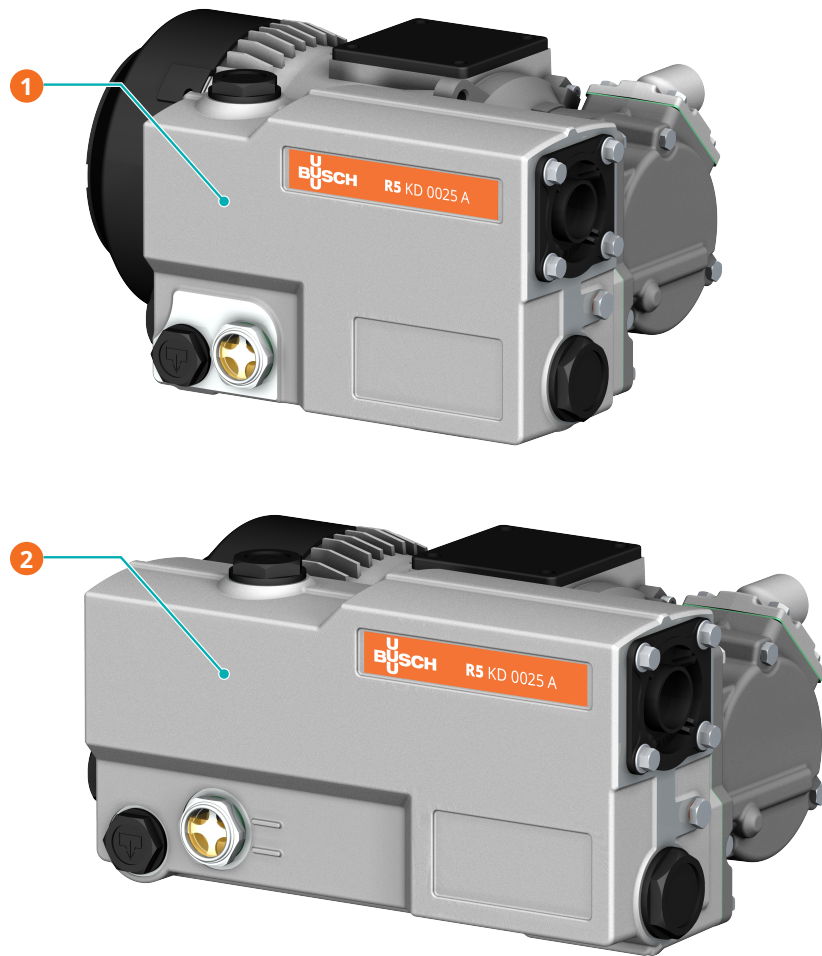

Description

1	Short oil separator (variant 1)	2	Long oil separator (variant 2)
---	---------------------------------	---	--------------------------------

2.4 Start Controls

The machine comes without start controls. The control of the machine is to be provided in the course of installation.

The machine can be equipped with a soft-starter.

2.5 Optional Accessories

2.5.1 Rubber feet

The rubber feet isolate and reduce the vibration of the machine.

Fix the pump unit to the housing. Use M6-screws for the rubber foot of long oil separator version and M8-screws for the short oil separator version and tighten them.

2.5.2 Extension Cables

Extension cables see Extension Cable Variants.

3 Transport



WARNING

Suspended load.

Risk of severe injury!

- Do not walk, stand or work under suspended loads.
-
- To find out the weight of the machine, refer to the chapter *Technical Data* [→ 27] or the nameplate (NP).

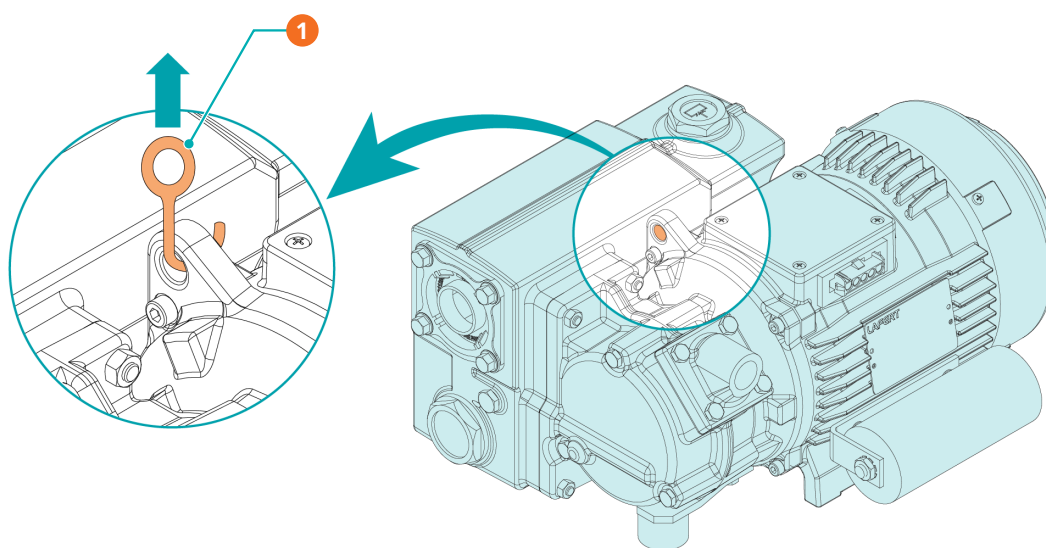

Description

1	Use the transport lug (TL) to lift the machine!	
---	-------------------------------------------------	--

- Check the machine for transport damage.
- If the machine is secured to a base plate:
- Remove the machine from the base plate.

4 Storage

- Seal all apertures with adhesive tape or reuse provided caps.

If the machine is to be stored for more than 3 months:

- Wrap the machine in a corrosion inhibiting film.
- Store the machine indoors, dry, dust free and if possible in original packaging preferably at temperatures between 0 ... 40 °C.

5 Installation

5.1 Installation Conditions

NOTICE

Use of the machine outside of the permitted installation conditions.

Risk of premature failure!

Loss of efficiency!

- Take care that the installation conditions are fully complied with.

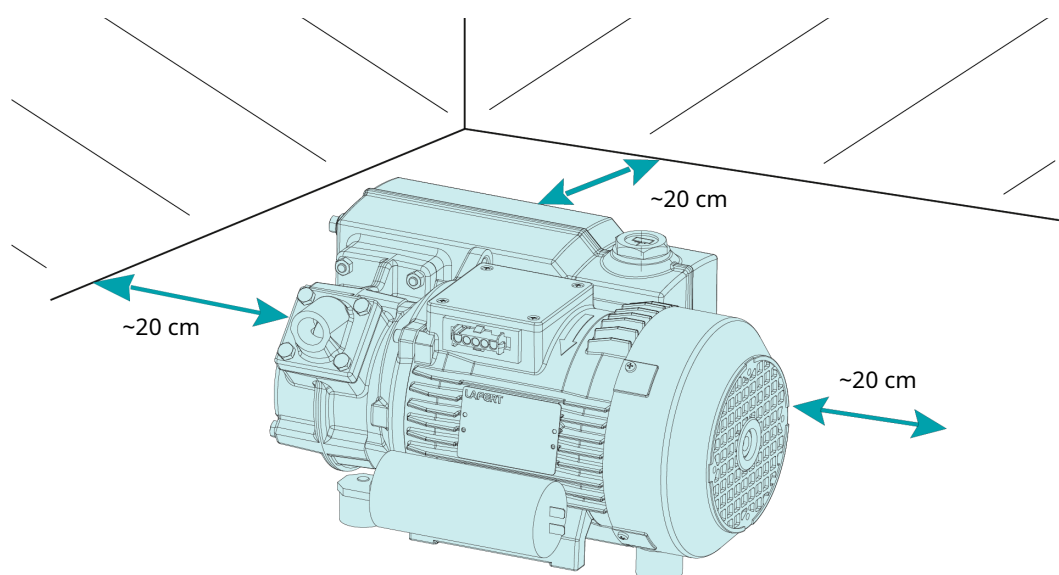

- Make sure that the environment of the machine is not potentially explosive.
- Make sure that the ambient conditions comply with the *Technical Data* [→ 27].
- Make sure that the environmental conditions comply with the protection class of the motor and the electrical elements.
- Make sure that the installation space or location is vented such that sufficient cooling of the machine is provided.
- Make sure that the oil sight glass (OSG) remains easily visible.
- Make sure that enough space remains for maintenance work.
- Make sure that the machine is placed or mounted horizontally, a maximum of 1° in any direction is acceptable.
- Check the oil level, fill up if necessary, see *Filling Oil* [→ 11].
- Make sure that all provided covers, guards, hoods, etc. are mounted.
- Fix the pump unit with M6-screws for the long oil separator version and M8-screws for the short oil separator version to the housing of the table top-packing machine.
- You can use the same fixing screws even if you use the rubber feet for absorbing vibrations.

These conditions are recommended installation conditions made by the manufacturer

Busch. If you have questions, contact Busch.

5.2 Connecting Lines / Pipes

- Remove all protective covers before installation.
- Make sure that the connection lines cause no stress on the machine's connection; if necessary use flexible joints.
- Make sure that the line size of the connection lines over the entire length is at least as large as the connections of the machine.

In case of long connection lines it is advisable to use larger line sizes in order to avoid a loss of efficiency. Seek advice from your Busch representative.

5.2.1 Suction Connection



NOTICE

Ingress of foreign objects or liquids.

Risk of damage to the machine!

If the inlet gas contains dust or other foreign solid particles:

- Install a suitable filter (5 micron or less) upstream from the machine.

Connection size(s):

- G1/2



NOTICE

Using the non-return valve as shut off valve.

Risk of oil mist flow back into the vacuum system.

- It is highly recommended not to use the non-return valve as a shut off system.

5.2.2 Discharge Connection



CAUTION

The discharge gas contains small quantities of oil.

Risk to health!

If air is discharged into rooms where persons are present:

- Make sure that sufficient ventilation is provided.

Connection size(s):

- Without connection. The discharged gas is released to the ambient of the machine.

5.3 Filling Oil

NOTICE

Use of an inappropriate oil.

Risk of premature failure!

Loss of efficiency!

- Only use an oil type which has previously been approved and recommended by Busch.

For oil type and oil capacity see *Technical Data* [→ 27] and *Oil* [→ 28].

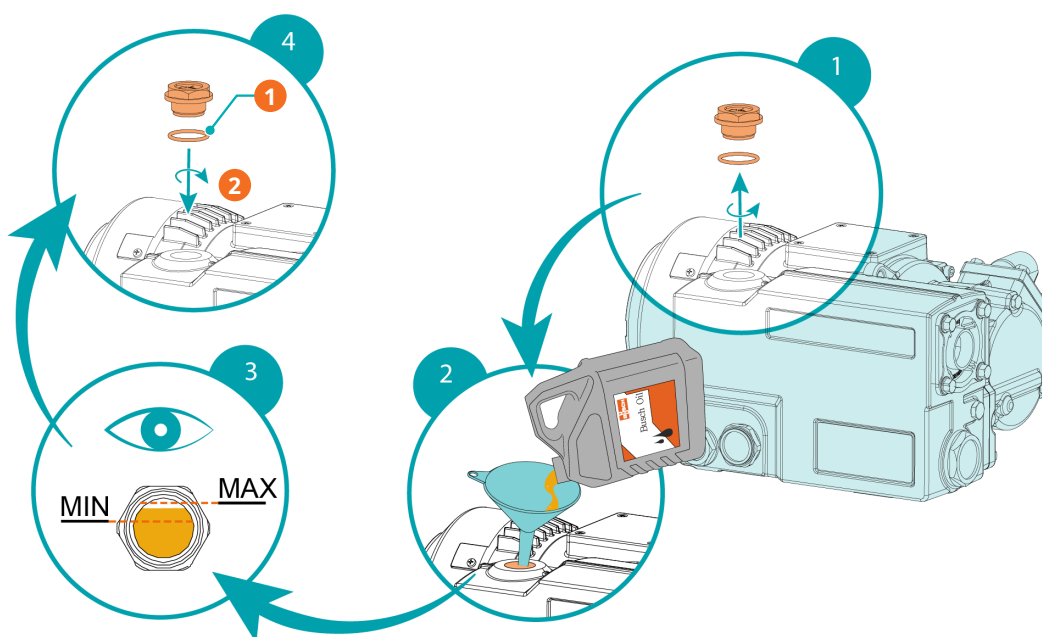

Description

1	1x o-ring, part no.: 0486 000 590	2	Tightening torque: 12 Nm
---	-----------------------------------	---	--------------------------

6 Electrical Connection



DANGER

Live wires.

Risk of electrical shock.

- Electrical installation work must only be executed by qualified personnel.

CURRENT PROTECTION OF THE CUSTOMER INSTALLATION:



DANGER

Missing current protection.

Risk of electrical shock.

- Current protection according to EN 60204-1 must be insured by the customer on its installation.
- The electrical installation must comply with the applicable national and international standards.



NOTICE

Electromagnetic compatibility.

- Make sure that the motor of the machine will not be affected by electric or electro-magnetic disturbance from the mains, if necessary seek advice from Busch.
- Make sure that the EMC of the machine is compliant with the requirements of your supply network system, if necessary provide further interference suppression (EMC of the machine, see *EU Declaration of Conformity* [→ 29] or *UK Declaration of Conformity* [→ 30]).

6.1 Machine delivered without Control Box or Variable Speed Drive (VSD)



DANGER

Live wires.

Risk of electrical shock.

- Electrical installation work must only be executed by qualified personnel.
- Make sure that the power supply for the motor is compatible with the data on the nameplate of the motor.
- If the machine is equipped with a power connector, install a residual current protective device to protect persons in case of isolation default.
 - Busch recommends installing a type B residual protective device suitable for the electrical installation.
- Provide a lockable disconnect switch or an emergency stop switch on the power line so that the machine is completely secured in case of an emergency situation.

- Provide a lockable disconnect switch on the power line so that the machine is completely secured during maintenance tasks.
- Provide an overload protection according to EN 60204-1 for the motor.
 - Busch recommends installing a D-curve circuit breaker.
- Install the capacitor (single phase motor only) and connect it to the capacitor connection (CC), see *Capacitor Installation* [→ 15].
- Electrically connect the motor.

6.2 Wiring Diagram Single-Phase Motor

Electrical Connection		Single-Phase Motor
Universal MATE-N-LOK cap housing		5 – Circuits (p/n 350810 – 1)
Contact type		Sockets (p/n 926882 – 1)
Contact Assignment	1	L1
	2	PE
	3	N
	4	Capacitor
	5	Capacitor

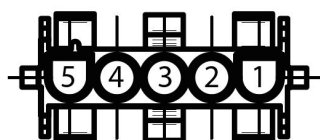

Motor Specifications	
Nominal motor rating	0.75 / 0.9 kW
Frame size and flange	80 / B34
Protection class	Min. IP 20
Insulation class	F
Duty type	S1 duty
Thermal motor protection	no
Connector type	AMP plug

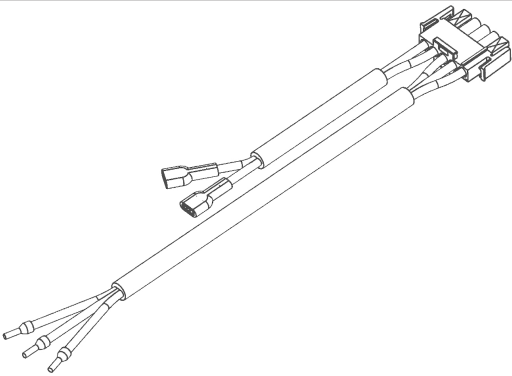
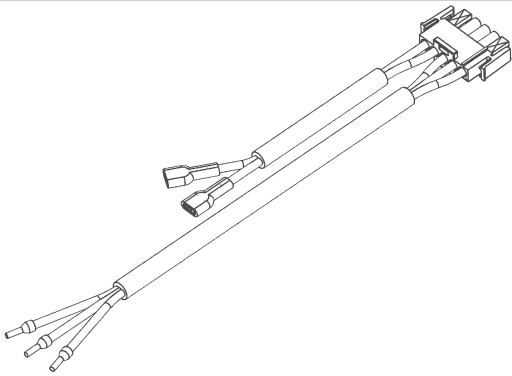
Extension Cable Variants	
AMP plug to wire end ferrules	AMP plug to wire end ferrules (cURus)
	
Length: 1000 mm	Length: 1000 mm
Part no.: 0671234891	Part no.: 0671239005

Motor Variants	Motor voltage	Motor frequency	Motor speed	Capacitor capacitance	Capacitor voltage
EU Single phase	220 - 240 V	50 / 60 Hz	3000 / 3600 min ⁻¹	60 µF	400 V
US Single phase	110 / 110 - 120 V	50 / 60 Hz	3000 / 3600 min ⁻¹	100 µF	250 V

6.3 Wiring Diagram Three-Phase Motor

Electrical Connection		Three-Phase Motor
Universal MATE-N-LOK cap housing		4 - Circuits (p/n 350780 - 1)
Contact type		Sockets (p/n 926882 - 1)
Contact Assignment	1	L1
	2	PE
	3	L2
	4	L3



NOTICE

Incorrect direction of rotation.

Risk of damage to the machine!

- Operation in the wrong direction of rotation can destroy the vacuum pump in a short time! Prior to starting-up make sure that the machine is operated in the right direction.

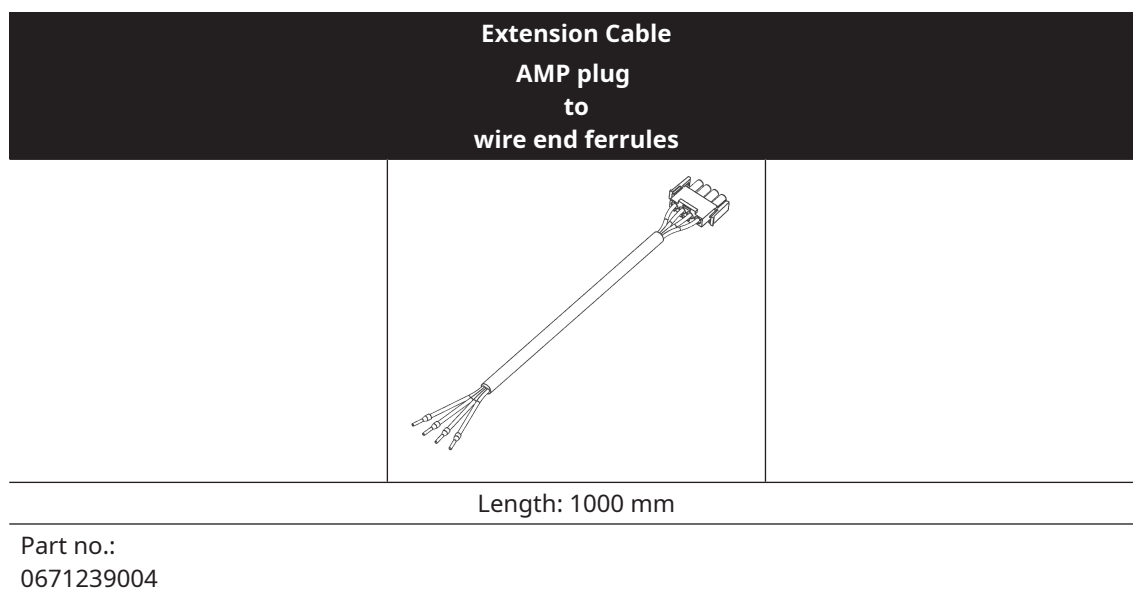

Motor Variant	Motor voltage	Motor frequency	Motor speed
JP	200 / 346 V	50 Hz	3000 UpM
Three phase	200 / 380 V	60 Hz	3600 UpM
	200 / 346 V	60 Hz	3600 UpM

6.4 Capacitor Installation

The machine needs a suitable capacitor (CAP) to operate, see Motor Variants.

Depending on the order, the scope of delivery contains one of the following delivery options.

- 1. Delivery option:** The capacitor (CAP) is delivered loosely

- Install the capacitor (CAP) on the capacitor's support (CS) of the motor and connect it with cable to power connection.

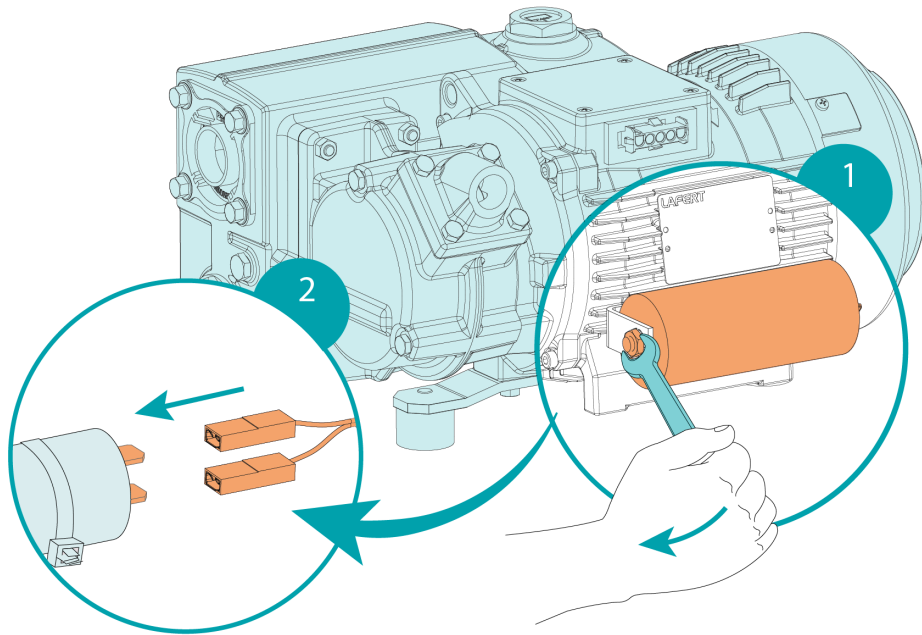

- For thermal reasons, the capacitor (CAP) can be mounted at a different location. Maximum distance of 230 mm (cable length) from the power connection.
- 2. Delivery option:** The capacitor (CAP) is installed and connected on the capacitor's support (CS)
- 3. Delivery option:** No capacitor (CAP)
- Depending on the motor, install a suitable capacitor (CAP), see Motor Variants.
 - Install the capacitor (CAP) on the capacitor's support (CS) of the motor and connect it with cable to power connection.

7 Commissioning

NOTICE

The machine can be shipped without oil.

Operation without oil will ruin the machine in short time!

- Prior to commissioning, the machine must be filled with oil, see *Filling Oil* [→ 11].



CAUTION

During operation the surface of the machine may reach temperatures of more than 70°C.

Risk of burns!

- Avoid contact with the machine during and directly after operation.

CAUTION



Noise of running machine.

Risk of damage to hearing!

If persons are present in the vicinity of a non noise insulated machine over extended periods:

- Make sure that ear protection is being used.
- Make sure that the installation conditions (see *Installation Conditions* [→ 9]) are met.
- Switch on the machine.
- Make sure that the operating conditions comply with the *Technical Data* [→ 27].
- After a few minutes of operation, perform an *Oil Level Inspection* [→ 19].

As soon as the machine is operated under normal operating conditions:

- Measure the motor current and record it as reference for future maintenance and trouble-shooting work.

7.1 Conveying Condensable Vapors

Water vapor within the gas flow is tolerated within certain limits. The conveyance of other vapors shall be agreed upon with Busch.

If condensable vapors are to be conveyed:

Before process:

- Warm up the machine for approximately half an hour.

After process:

- Operate the machine for approximately another half an hour.

8 Maintenance



DANGER

Live wires.

Risk of electrical shock.

- Electrical installation work must only be executed by qualified personnel.



WARNING



Machines contaminated with hazardous material.

Risk of poisoning!

Risk of infection!

If the machine is contaminated with hazardous material:

- Wear appropriate personal protective equipment.



CAUTION

Hot surface.

Risk of burns!

- Prior to any action requiring touching the machine, let the machine cool down first.



CAUTION

Failing to properly maintain the machine.

Risk of injuries!

Risk of premature failure and loss of efficiency!

- Maintenance work must only be executed by qualified personnel.
- Respect the maintenance intervals or ask your Busch representative for service.



NOTICE

Using inappropriate cleaners.

Risk of removing safety stickers and protective paint!

- Do not use incompatible solvents to clean the machine.

- Shut down the machine and lock against inadvertent start up.
- Vent the connected lines to atmospheric pressure.

If necessary:

- Disconnect all connections.

8.1 Maintenance Schedule

The maintenance intervals depend very much on the individual operating conditions. The intervals given below are considered as starting values which should be shortened or extended as appropriate. Particularly harsh applications or heavy duty operation, such as high dust loads in the environment or in the process gas, other contamination or ingress of process material, can make it necessary to shorten the maintenance intervals significantly.

Interval	Maintenance work
Daily	<ul style="list-style-type: none"> Check the oil level, see <i>Oil Level Inspection</i> [→ 19].
Weekly	<ul style="list-style-type: none"> Check the machine for oil leaks - in case of leaks have the machine repaired (contact Busch).
Every 2000 hours or every 6 months	<ul style="list-style-type: none"> Change the oil and the exhaust filters (EF).
Every 5 years	<ul style="list-style-type: none"> Have a major overhaul on the machine (contact Busch).

8.2 Oil Level Inspection

- Shut down the machine.
- When the machine is stopped, wait 1 minute before checking the oil level.



- Fill up if necessary, see *Oil Filling* [→ 11].

8.3 Oil Change



Use of an inappropriate oil.

Risk of premature failure!

Loss of efficiency!

- Only use an oil type which has previously been approved and recommended by Busch.

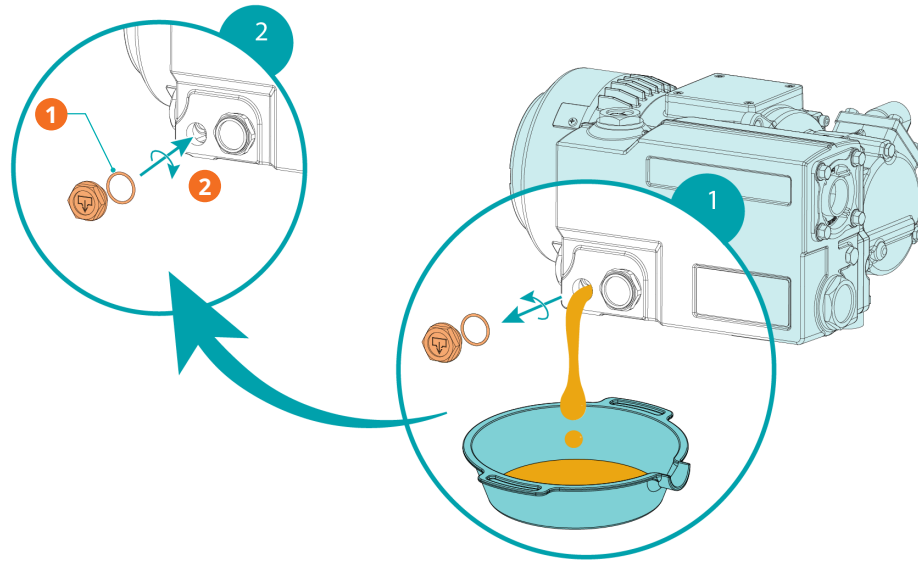

Description			
1	1x o-ring, part no.: 0486 000 505	2	Tightening torque: 12 Nm

For oil type and oil capacity see *Technical Data* [→ 27] and *Oil* [→ 28].

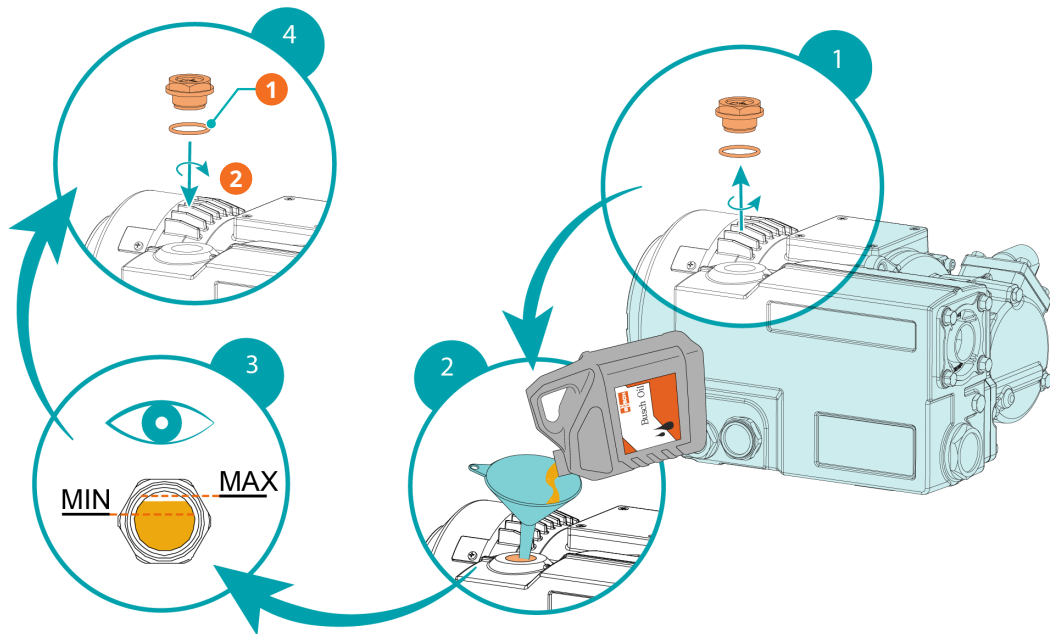

Description			
1	1x o-ring, part no.: 0486 000 590	2	Tightening torque: 12 Nm

8.4 Exhaust Filter Change

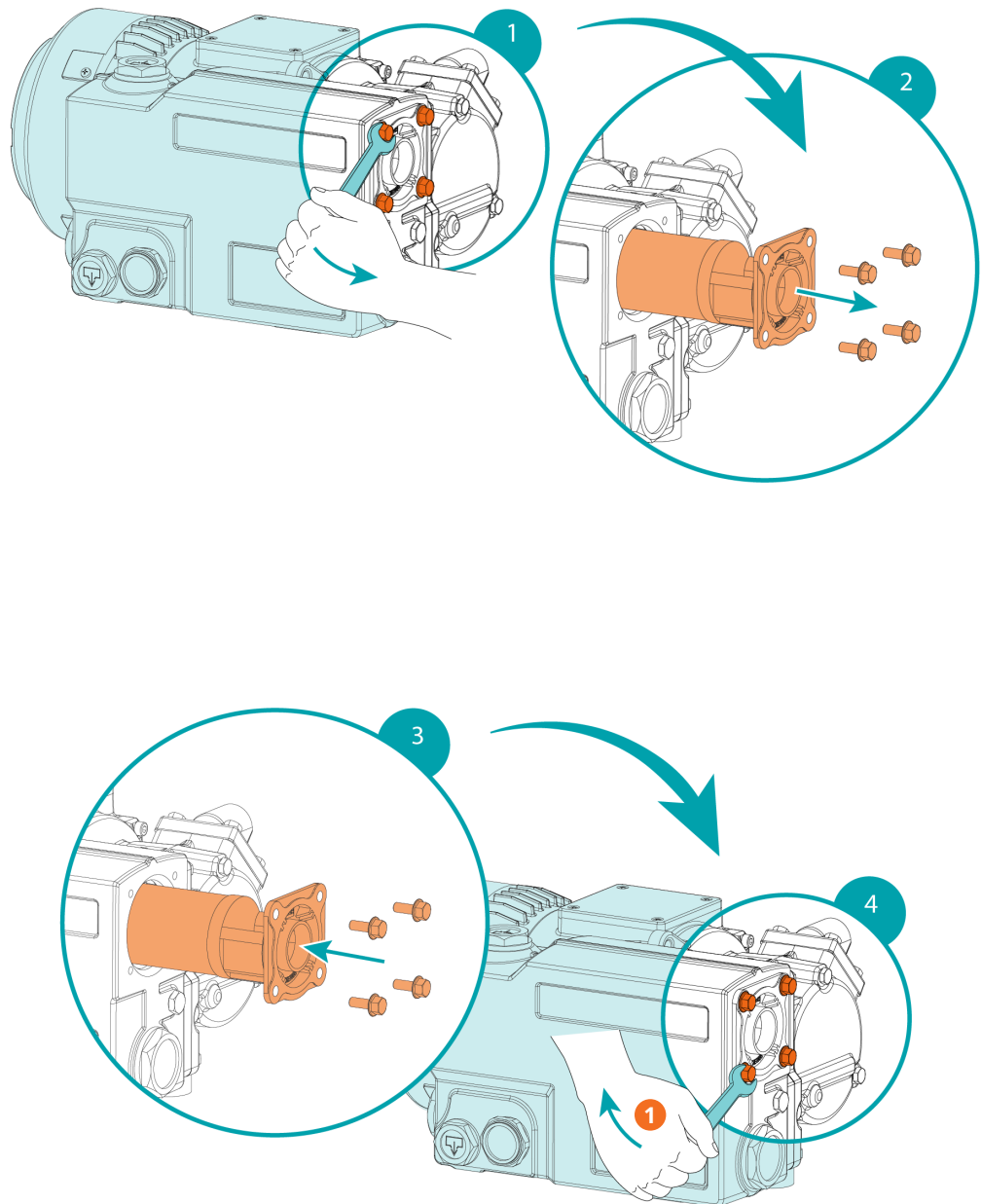

Description

1	Tightening torque: 4 Nm		
---	-------------------------	--	--

9 Overhaul



WARNING



Machines contaminated with hazardous material.

Risk of poisoning!

Risk of infection!

If the machine is contaminated with hazardous material:

- Wear appropriate personal protective equipment.



NOTICE

Improper assembly.

Risk of premature failure!

Loss of efficiency!

- Any dismantling of the machine that goes beyond anything that is described in this manual should be done by Busch authorized technicians.

In case of the machine having conveyed gas that was contaminated with foreign materials which are dangerous to health:

- Decontaminate the machine as much as possible and state the contamination status in a 'Declaration of Contamination'.

Busch will only accept machines that come with a completely filled in and legally binding signed 'Declaration of Contamination' (form downloadable from www.buschvacuum.com).

10 Decommissioning



DANGER

Live wires.

Risk of electrical shock.

- Electrical installation work must only be executed by qualified personnel.



CAUTION

Hot surface.

Risk of burns!

- Prior to any action requiring touching the machine, let the machine cool down first.

- Shut down the machine and lock against inadvertent start up.
- Disconnect the power supply.
- Vent the connected lines to atmospheric pressure.
- Disconnect all connections.

If the machine is going to be stored:

- See *Storage* [→ 8].

10.1 Dismantling and Disposal

- Drain and collect the oil.
- Make sure that no oil drips onto the floor.
- Remove the exhaust filters.
- Separate special waste from the machine.
- Dispose of special waste in compliance with applicable regulations.
- Dispose of the machine as scrap metal.

11 Spare Parts



NOTICE

Use of non-Busch genuine spare parts.

Risk of premature failure!

Loss of efficiency!

- The exclusive use of Busch genuine spare parts and consumables is recommended for the correct functioning of the machine and to validate the warranty.

Spare part kit	Description	Part no.
Service kit KD 0025 A	Includes all the necessary parts for maintenance	0990 241 154

If other parts are required:

- Contact your Busch representative.

12 Troubleshooting



DANGER

Live wires.

Risk of electrical shock.

- Electrical installation work must only be executed by qualified personnel.



CAUTION

Hot surface.

Risk of burns!

- Prior to any action requiring touching the machine, let the machine cool down first.

Illustration showing parts that may be involved during troubleshooting:

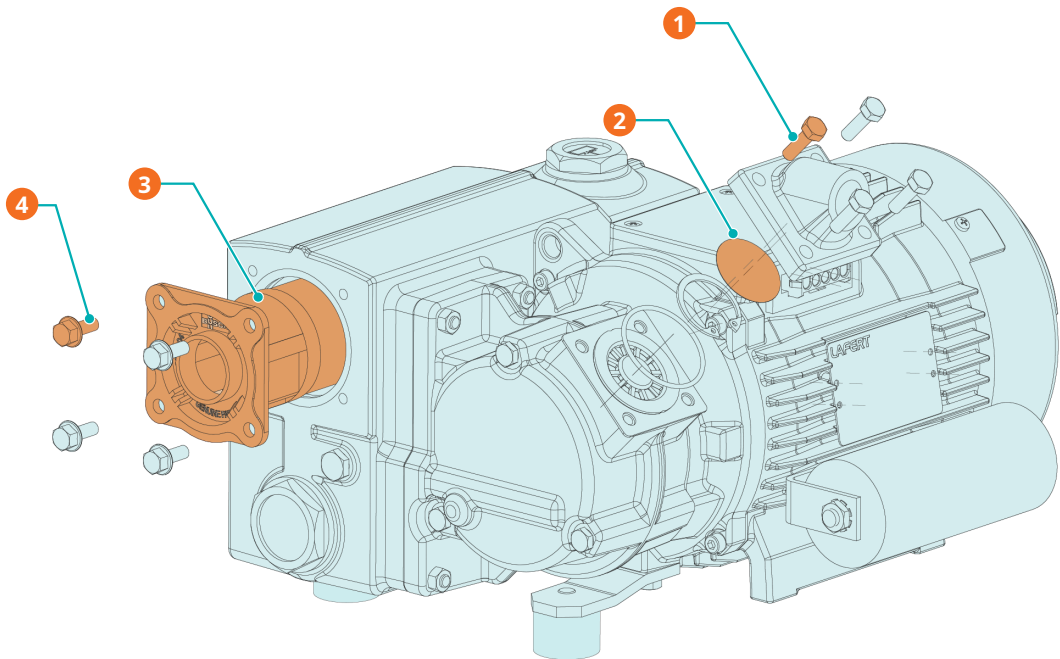

Description			
1	Tightening torque: 10 Nm	2	Inlet screen (IS)
3	Exhaust filter (EF)	4	Tightening torque: 4 Nm

Problem	Possible Cause	Remedy
The machine does not start.	The motor is not supplied with the correct voltage.	<ul style="list-style-type: none"> • Check the power supply. • Have the machine repaired (contact Busch Service).
	The capacitor is defective. (Single phase motor only)	<ul style="list-style-type: none"> • Check the capacitor as well as the connection.
	The machine heated up, disconnection by bimetallic element.	<ul style="list-style-type: none"> • Have the machine cool down.
The machine does not reach the usual pressure on the suction connection.	Oil level too low.	<ul style="list-style-type: none"> • Top up oil.
	The inlet screen (IS) is partially clogged.	<ul style="list-style-type: none"> • Clean the inlet screen (IS).
	Internal parts are worn or damaged.	<ul style="list-style-type: none"> • Repair the machine (contact Busch).
The machine runs very noisily.	Stuck vanes.	<ul style="list-style-type: none"> • Repair the machine (contact Busch).
	Defective bearings.	<ul style="list-style-type: none"> • Repair the machine (contact Busch).
The machine runs too hot.	Insufficient cooling.	<ul style="list-style-type: none"> • Remove dust and dirt from the machine.
	Ambient temperature too high.	<ul style="list-style-type: none"> • Observe the permitted ambient temperature.
	Oil level too low.	<ul style="list-style-type: none"> • Top up oil.
	The exhaust filters (EF) are partially clogged.	<ul style="list-style-type: none"> • Replace the exhaust filters (EF).
The machine fumes or expels oil droplets through the gas discharge.	The exhaust filters (EF) are partially clogged.	<ul style="list-style-type: none"> • Replace the exhaust filters (EF).
	An exhaust filter (EF) with o-ring is not fitted properly.	<ul style="list-style-type: none"> • Ensure the correct position of the exhaust filters (EF) and the o-rings.
The oil is black.	Oil change intervals are too long.	<ul style="list-style-type: none"> • Flush the machine (contact Busch).
	The machine runs too hot.	<ul style="list-style-type: none"> • See problem "The machine runs too hot".
The oil is emulsified.	The machine sucked in liquids or significant amounts of vapor.	<ul style="list-style-type: none"> • Flush the machine (contact Busch).

For the solution of problems not mentioned in the troubleshooting chart contact your Busch representative.

13 Technical Data

KD 0025 A		
Nominal pumping speed (50Hz / 60Hz)	m ³ /h	22 / 25
Ultimate pressure (50Hz / 60 Hz)	hPa (mbar) abs.	2 / 2
Nominal motor rating (50Hz / 60Hz)	kW	0.75 / 0.9
Duty type		S1 duty
Nominal motor speed (50Hz / 60Hz)	min ⁻¹	3000 / 3600
Ambient temperature range	°C	5 ... 40
Gas inlet temperature	°C	5 ... 40
Ambient pressure		Atmospheric pressure
Oil capacity (short oil separator)	l	0.3
Oil capacity (long oil separator)	l	0.45
Weight	kg	21

** Depending on the use of the pump under these conditions, other oil types might be more appropriate! Contact Busch for specification.

14 Oil

	VSA 032	VSB 032
ISO-VG	32	
Oil type	Synthetic oil	
Certifications	H1 Kosher* Halal*	
Part number: 1 L pack-aging	0831 163 958	0831 168 343
Part number: 5 L pack-aging	0831 163 961	0831 168 344
Remark	Light cycle operation	Heavy duty cycle operation
	Food applications (H1)	

*Certificates are available on request or per download under www.buschvacuum.com.

In case of unfavorable ambient temperature, other oil viscosities may be used. Please consult your Busch representative for more details.

15 EU Declaration of Conformity

This Declaration of Conformity and the CE-markings affixed to the nameplate are valid for the machine within the Busch scope of delivery. This Declaration of Conformity is issued under the sole responsibility of the manufacturer.

When this machine is integrated into a superordinate machinery the manufacturer of the superordinate machinery (this can be the operating company, too) must conduct the conformity assessment process for the superordinate machine or plant, issue the Declaration of Conformity for it and affix the CE-marking.

The manufacturer

Busch Produktions GmbH
Schauinslandstr. 1
DE-79689 Maulburg

declares that the machine: R5 KD 0025 A

fulfill(s) all the relevant provisions from EU directives:

- 'Machinery' 2006/42/EC
- 'Electromagnetic Compatibility' (EMS) 2014/30/EU
- 'RoHS' 2011/65/EU Restriction of the use of certain hazardous substances in electrical and electronic equipment (incl. all related applicable amendments)

and comply(-ies) with the following designated standards that have been used to fulfill those provisions:

Standards	Title of the Standard
EN ISO 12100 : 2010	Safety of machinery - Basic concepts, general principles of design
EN ISO 13857 : 2019	Safety of machinery - Safety distances to prevent hazard zones being reached by the upper and lower limbs
EN 1012-2 : 1996 + A1 : 2009	Vacuum pumps - Safety requirements - Part 2
EN ISO 2151 : 2008	Acoustics - Noise test code for compressors and vacuum pumps - Engineering method (grade 2)
EN 60204-1 : 2018	Safety of machinery - Electrical equipment of machines - Part 1: General requirements
EN IEC 61000-6-2 : 2019	Electromagnetic compatibility (EMC) - Generic standards. Immunity for industrial environments
EN IEC 61000-6-4 : 2019	Electromagnetic compatibility (EMC) - Generic standards. Emission standard for industrial environments

Legal person authorized to compile the technical file and authorized representative in the EU (if the manufacturer is not located in the EU):

Busch Dienste GmbH
 Schauinslandstr. 1
 DE-79689 Maulburg

Maulburg, 18.08.2021



Dr. Martin Gutmann
General Manager
Busch Produktions GmbH

16 UK Declaration of Conformity

This Declaration of Conformity and the UKCA-markings affixed to the nameplate are valid for the machine within the Busch scope of delivery. This Declaration of Conformity is issued under the sole responsibility of the manufacturer.

When this machine is integrated into a superordinate machinery the manufacturer of the superordinate machinery (this can be the operating company, too) must conduct the conformity assessment process for the superordinate machine or plant, issue the Declaration of Conformity for it and affix the UKCA-marking.

The manufacturer

Busch Produktions GmbH
Schauinslandstr. 1
DE-79689 Maulburg

declares that the machine: R5 KD 0025 A

fulfill(s) all the relevant provisions from UK legislations:

- Supply of Machinery (Safety) Regulations 2008
- Electromagnetic Compatibility Regulations 2016
- Restriction of the use of certain hazardous substances in Electrical and Electronic Equipment Regulations 2021

and comply(-ies) with the following designated standards that have been used to fulfill those provisions:

Standards	Title of the Standard
EN ISO 12100 : 2010	Safety of machinery - Basic concepts, general principles of design
EN ISO 13857 : 2019	Safety of machinery - Safety distances to prevent hazard zones being reached by the upper and lower limbs
EN 1012-2 : 1996 + A1 : 2009	Vacuum pumps - Safety requirements - Part 2
EN ISO 2151 : 2008	Acoustics - Noise test code for compressors and vacuum pumps - Engineering method (grade 2)
EN 60204-1 : 2018	Safety of machinery - Electrical equipment of machines - Part 1: General requirements
EN IEC 61000-6-2 : 2019	Electromagnetic compatibility (EMC) - Generic standards. Immunity for industrial environments
EN IEC 61000-6-4 : 2019	Electromagnetic compatibility (EMC) - Generic standards. Emission standard for industrial environments

Legal person authorized to compile the technical file and importer in the UK
 (if the manufacturer is not located in the UK):

Busch (UK) Ltd
 30 Hortonwood
 Telford - UK

Maulburg, 18.08.2021



Dr. Martin Gutmann
General Manager
Busch Produktions GmbH

Notes

A large grid of small dots, intended for taking notes. The grid consists of approximately 30 columns and 40 rows of dots, providing a structured space for writing.

Busch

Vacuum Solutions

With a network of over 60 companies in more than 40 countries and agencies worldwide, Busch has a global presence. In every country, highly competent local personnel delivers custom-tailored support backed by a global network of expertise. Wherever you are. Whatever your business. We are there for you.

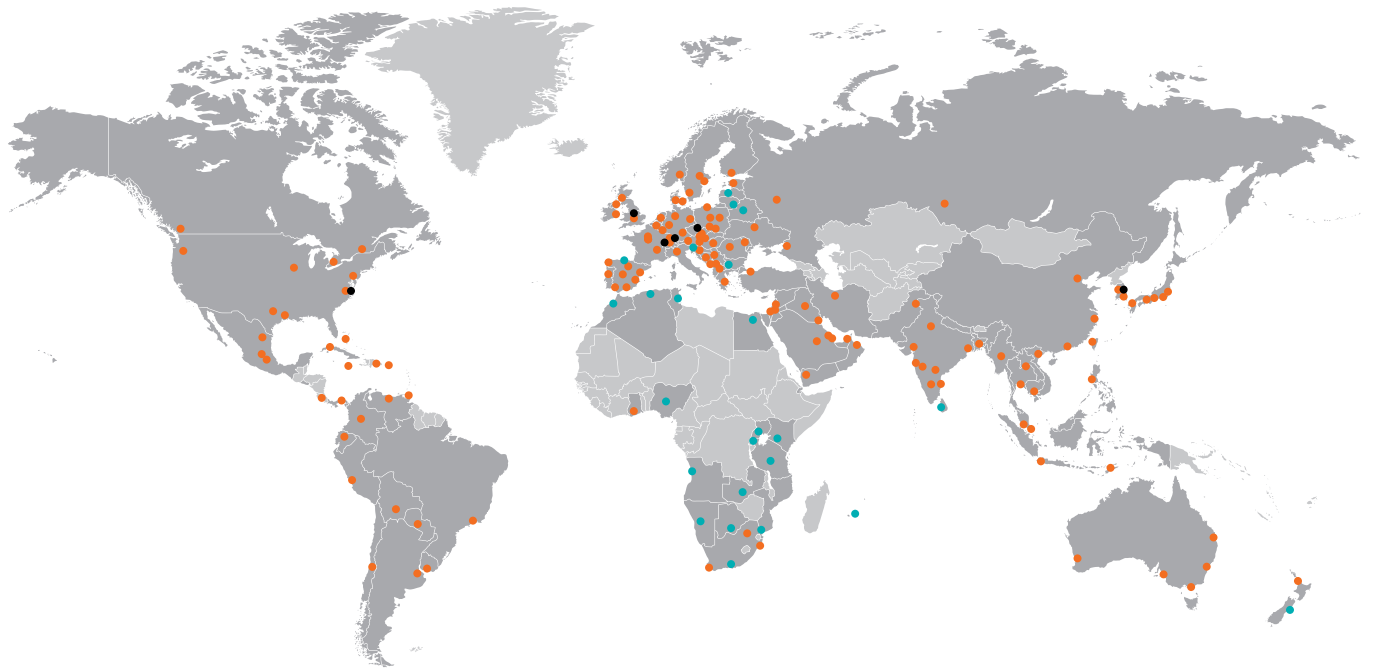

● Local representatives and distributors ● Busch companies and Busch employees ● Busch production site

www.buschvacuum.com