

# COBRA DX 2000 A PLUS

Dry screw vacuum pump



VACUUM SOLUTIONS



Version in illustration with cabinet, standard version comes without cabinet

## Plug&Pump

Easy to install, user-friendly thanks to a control panel with touch screen and intuitive user interface

## Cost savings

Reduced energy consumption with ECOTORQUE Drive, minimized operating costs, minimal maintenance thanks to dry screw vacuum technology

## High performance

High pumping speed, two COBRA NX 0950 A on a common base frame with single control unit

Accessories, spare parts and options

- Speed or pressure control
- Water cooling or air cooling system
- Barrier gas system
- Iot Kit
- Cabinet
- Electro-pneumatic inlet valve
- Dilution gas valve
- Industrial quick connector
- Main switch
- Xylan-Defric coating
- Outlet silencer
- Remote control package with communication ports for quick connection and monitoring of the pump

# COBRA DX 2000 A PLUS

Dry screw vacuum pump



Dimensional drawing

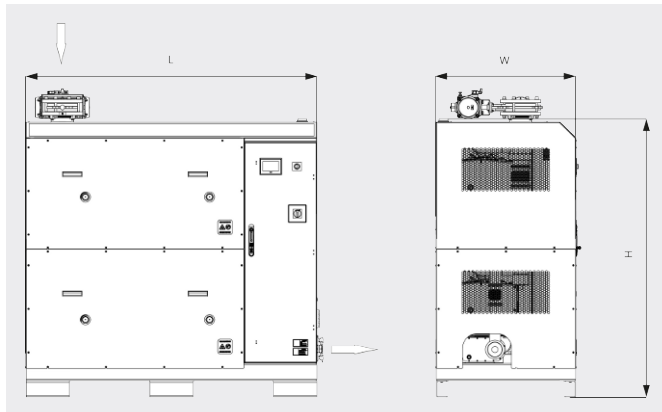

Pumping speed  
Air at 20°C. Tolerance:  $\pm 10\%$

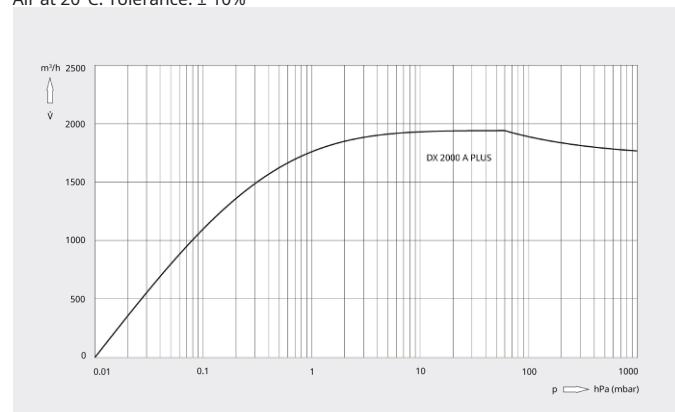

COBRA DX 2000 A PLUS	
Nominal pumping speed	1900 m³/h
Ultimate pressure	$\leq 0.01$ hPa (mbar)
Nominal motor rating	2 x 18.5 kW
Nominal motor speed	4320 min <sup>-1</sup>
Sound pressure level (ISO 2151), KpA = 3 dB	$\leq 76$ dB(A)
Weight approx.	2750 kg
Dimensions (L x W x H)	2035 x 983 x 1950 mm
Gas inlet / outlet	DN 160 ISO-K / DN 100 ISO-K

## DO YOU WANT TO KNOW MORE?

Get in touch with us directly!  
[info@busch.com.tr](mailto:info@busch.com.tr) or +90 216 912 46 04



CONTACT FORM



CALL NOW