

# STF 0100–1600

Standing filters



VACUUM SOLUTIONS



Busch standing filters are placed upstream of the vacuum pump and protect it from damage caused by process contaminants such as dust, pastes and moderate levels of liquid.

## Ideal protection

Two-stage separation process of contaminants for longer lifetime of the vacuum pump

## Application-oriented

Different filter inserts for high flexibility, easy replacement of inserts according to process requirements

## Easy servicing

Manual drain, removable top lid for easy removal of filter inserts, large side opening for simplified access to lower part for cleaning purposes

Accessories, spare parts and options

- Filtering bag for dust applications
- Demister insert for moist, liquid and sticky substances
- Fleece insert for dust and liquids (depending on size)
- Mild steel and stainless steel versions available (depending on size and filter element)

# STF 0100–1600

Standing filters



**VACUUM SOLUTIONS**

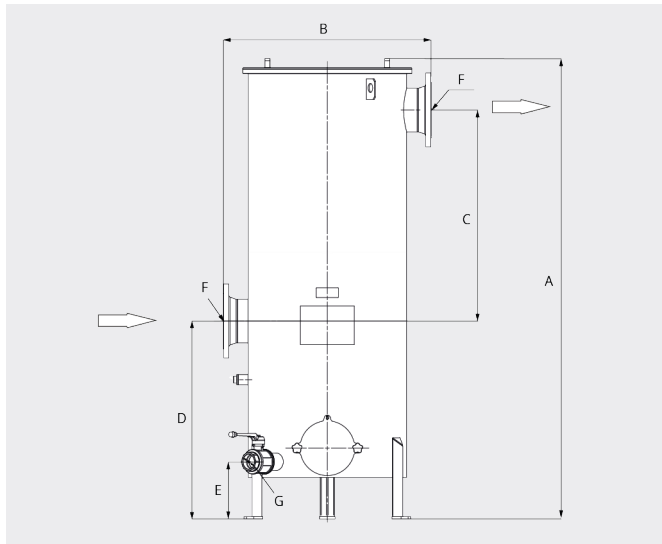

	STF 0100	STF 0250	STF 0630	STF 1600
<b>A</b>	695 mm	1101 mm	1439 mm	1768 mm
<b>B</b>	410 mm	500 mm	640 mm	800 mm
<b>C</b>	300 mm	420 mm	570 mm	810 mm
<b>D</b>	300 mm	560 mm	750 mm	760 mm
<b>E</b>	140 mm	205 mm	215 mm	220 mm
<b>F</b>	DN40 PN40	DN50 PN16	DN80 PN16	DN150 PN16
<b>G</b>	G 1½"	G 1½"	G 2"	G 2"

	STF 0100	STF 0250	STF 0630	STF 1600
<b>Liquid capacity</b>	9 l	25 l	70 l	100 l
<b>Max. pumping speed</b>	100 m³/h	250 m³/h	630 m³/h	1600 m³/h
<b>Ambient temperature</b>	5 ... 40 °C	5 ... 40 °C	5 ... 40 °C	5 ... 40 °C
<b>Weight approx.</b>	60 kg	80 kg	175 kg	275 kg
<b>Dimensions (W x H x Ø)</b>	410 x 695 x 324 mm	500 x 1101 x 380 mm	640 x 1439 x 520 mm	800 x 1768 650 x mm

**DO YOU WANT TO KNOW MORE?**

Get in touch with us directly!



CONTACT FORM