

# COBRA DS 3181 C

Dry screw vacuum pump



Discover all advantages of the product series COBRA DS

## High performance

Advanced screw design, excellent running qualities, integrated vacuum booster, perfectly suited for chemical vapor deposition, rapid thermal processing or atomic layer deposition

## Efficient

Low cost of ownership, minimal maintenance, long service intervals, high uptime, efficient indirect water cooling

## Compact

Fit-in-place design, directly mounted canned motor, backing pump and vacuum booster combined on a compact base frame

### Accessories

- Optional powder process version available

# COBRA DS 3181 C

Dry screw vacuum pump



VACUUM SOLUTIONS

## Dimensional drawing

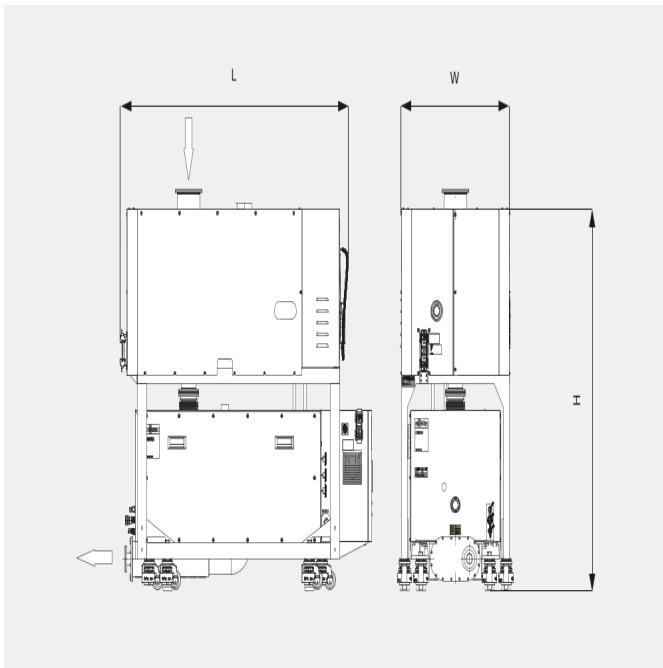

## Pumping speed

Air at 20 °C. Tolerance:  $\pm 10\%$

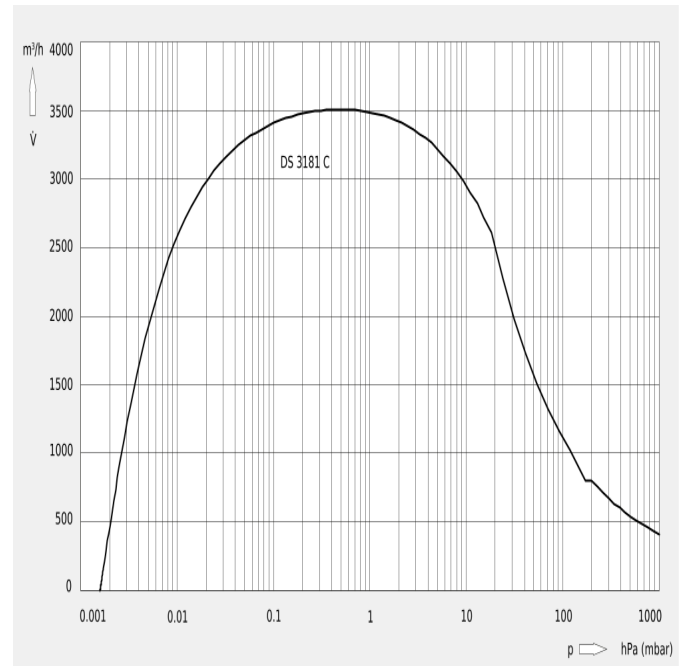

The following technical values refer to ISO 50 Hz

COBRA DS 3181 C	
Nominal pumping speed	3500 m <sup>3</sup> /h
Ultimate pressure	0.001 hPa (mbar)
Nominal motor rating backing pump	18.5 kW
Nominal motor rating vacuum booster	15.0 kW
Power consumption at ultimate pressure	12.4 kW
Power consumption idle mode	10.3 kW
Nominal motor speed backing pump	4320 min <sup>-1</sup>
Nominal motor speed vacuum booster	5400 min <sup>-1</sup>
Sound pressure level (ISO 2151)	< 75 dB(A)
Water consumption	min. 10 l/min

# COBRA DS 3181 C

Dry screw vacuum pump



COBRA DS 3181 C	
Nitrogen consumption	0 – 200 l/min
Weight approx.	1500 kg
Dimensions (L x W x H)	1654 x 722 x 1452 mm
Gas inlet	DN 160
Gas outlet	DN 63

The following technical values refer to ISO 60 Hz

COBRA DS 3181 C	
Nominal pumping speed	3500 m <sup>3</sup> /h
Ultimate pressure	0.001 hPa (mbar)
Nominal motor rating backing pump	18.5 kW
Nominal motor rating vacuum booster	15.0 kW
Power consumption at ultimate pressure	12.4 kW
Power consumption idle mode	10.3 kW
Nominal motor speed backing pump	4320 min <sup>-1</sup>
Nominal motor speed vacuum booster	5400 min <sup>-1</sup>
Sound pressure level (ISO 2151)	< 75 dB(A)
Water consumption	min. 10 l/min
Nitrogen consumption	0 – 200 l/min
Weight approx.	1500 kg
Dimensions (L x W x H)	1654 x 722 x 1452 mm
Gas inlet	DN 160
Gas outlet	DN 63

## DO YOU WANT TO KNOW MORE

Please contact us!  
sales@busch.com.au or +61 (0)1800 639 087



CONTACT FORM



CALL US NOW